

Title	Installation manual CI-P2
Language	English
Version	1.01
Date	May 12 th 2020
Applicable to	CI-P2 in Volvo S60/V70/XC70/S80
Contents	Manual describes the installation of the interface.

Radio canbus interface P2

Pre requirements

APPLICABLE TO:

Volvo S60 (MY 2000-2009), V70 (MY2000-2007), XC70 (MY2000-2007), S80 (MY 1999-2006),

In case of replacing the original HU (Head Unit) for an aftermarket radio (from Pioneer, Blaupunkt, Alpine, Clarion, JVC, Kenwood, Zenec or Digitaldynamic).

Or:

In case a analogue output is required for either one of the supported functions.

Starting points:

All normal functions should be working and in good state before starting this installation.

Required tools:

Any tool required to install an aftermarket radio.

In case you use the CI-P2 for an analogue output only, refer to the specific user manual of the device to be connected please!

START

© 2020 SwedeSolutions the Netherlands - info@swedesolutions.com - www.swedesolutions.com

Instruction# 1698	Version# 1.00	Part# ntbp	EAN#	Author: KW
-------------------	---------------	------------	------	------------

STEP 0 prepare your Volvo:

Remove key from ignition and only put the key back into the ignition once ALL connections are made or all connectors are put back into original position.

STEP 1 (-MY 2004) Remove pen-holder and gear-shift-cover:

Remove the pen-holder. (Pull it carefully in the direction of the gear-shifter).
Unlock and remove the panel around the gear-shifter by gently but firmly pressing the 4 clips.

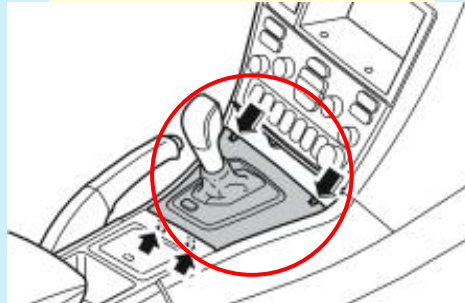
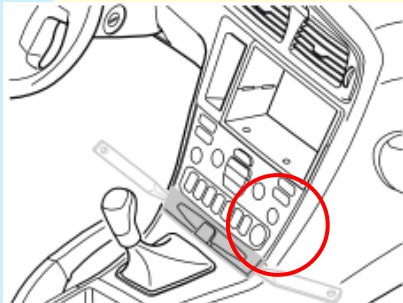

STEP 2 (-MY 2004) removing climate-control-panel:

Remove the 2 (Torx) screws from the temperature control unit (the lower part of the whole panel) and move the bottom of that panel towards the gear-shifter. Then remove it carefully by pulling it out.

DO NOT REMOVE ANY CABLES FROM THIS PANEL besides the cigarette lighter connector.
Now put the unit carefully **on a towel** (to avoid damages) on the left side of the tunnel and leave it there.

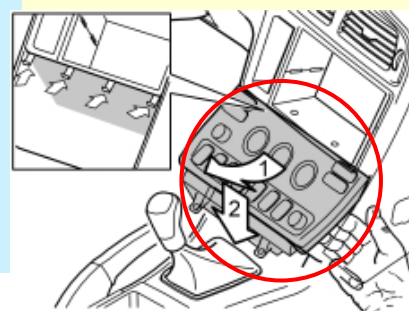

Instruction# 1697	Version# 1.06	Part# ntbp	EAN#	Author: KW
-------------------	---------------	------------	------	------------

STEP 1 (MY 2004 -) remove the gear-shift-cover.

Remove the gear-shift-cover. Pull the panel up (preferably with a Fishbone tool) and then unclip the bottom parts.

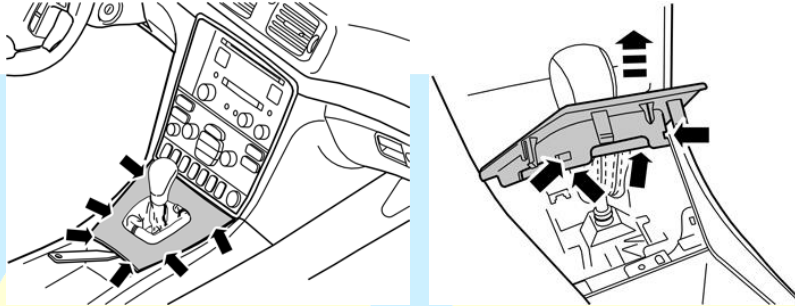

Step 2 (MY 2004 -) remove the radio/climate-control panel

Remove the 2 torx screws on the bottom part of the radio -climate-control-panel. Tilt the radio forward (bottom) and pull the whole part out.

If you drive a automatic/geartronic, you'll have to put the gear-lever into D or even Manual to be able to pull the panel out.

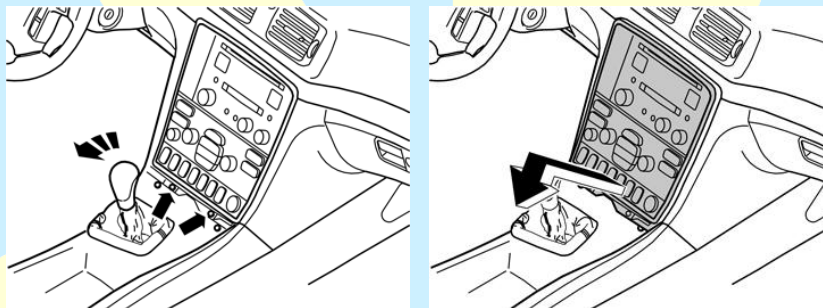

STEP 3 removing HU:

This will be removing your aftermarket radio.

Tools to remove have been supplied with your radio!

Instruction# 1697	Version# 1.06	Part# ntbp	EAN#	Author: KW
-------------------	---------------	------------	------	------------

STEP 4 –Connections:

Connect the supplied 12pin and 4pin connector to the CI-P2.

(Depending on the order you made, you'll have a direct full harness connecting plug-and-play to the original Volvo harness or a manual-connect set.)

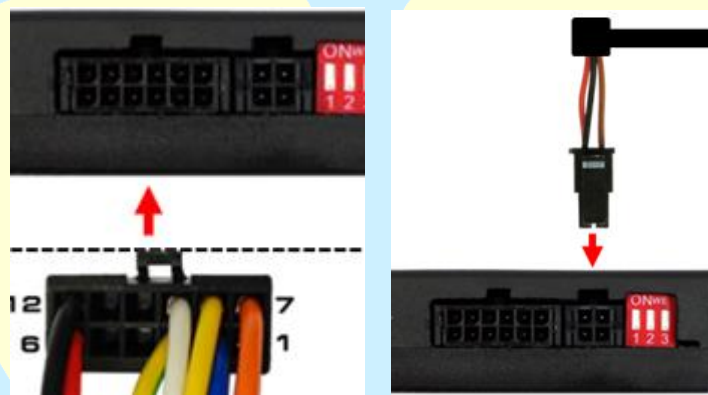

Connecting the speaker:

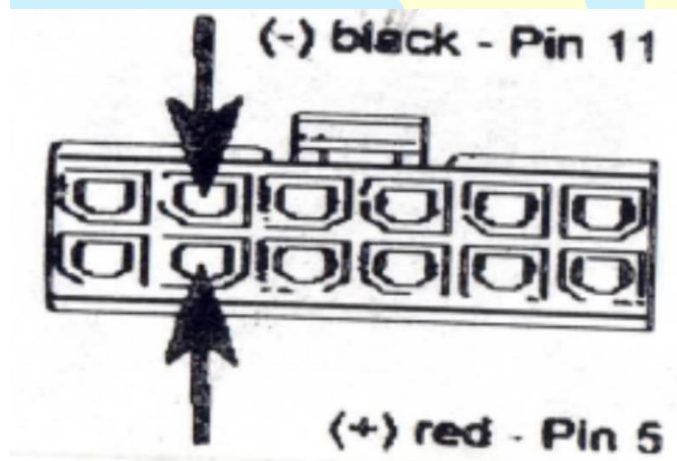

Instruction# 1697	Version# 1.06	Part# ntbp	EAN#	Author: KW
-------------------	---------------	------------	------	------------

Set the DIP-switches.

Currently we only supply the SE-CI-P2-104 as default.

Harness	Description	Dip1	Dip2	Dip3
SE-CI-P2-103	Control cable set for Blaupunkt (ext. control over Mini-ISO connection)	on	off	off
SE-CI-P2-104	Control cable set for Alpine	off	off	off
	Control cable set for Clarion	on	on	off
	Control cable set for JVC	on	off	on
SE-CI-P2-105	Control cable set for Kenwood, or with open ends (Manual connect)	on	on	on
SE-CI-P2-106	Control cable set for Kenwood, with DIN-connection	on	on	on
SE-CI-P2-107	Control cable set for Pioneer	off	on	on
	Blaupunkt (ext. control over Mini-Jack connection)	off	on	off
SE-CI-P2-108	Control cable set for Zenec and Digitaldynamic	off	off	on

CONNECT THE CI-P2 HARNESS TO THE ORIGINAL HARNESS IN YOUR VOLVO.

In case you ordered the **plug-and-play connection set** you'll just have to disconnect any current connectors from the grey and green connectors in your Volvo.

Connect the CI-P2 connectors to the original connectors.

In case you have the **manual-connection set**, you'll need to follow guidelines below:

Canbus wiring:

S60, V70

Female 12pin connector in radio slot

CAN High – **Pin 7** (white)

CAN Low – **Pin 8** (green)

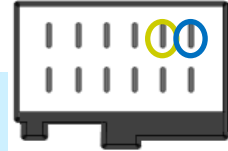

Assignment of the 12-pin connector at the CI-P2

Cable colour	Assignment
Pin 1 ● pink	+12V ACC (Output) max.1.5A
Pin 2 ● blue	CAN-LOW (Input)
Pin 3 ●● yellow/green	Tachometer signal (Output)
Pin 5 ● red	+ signal PDC
Pin 6 ● red	+12V Permanent (Input)
Pin 7 ● orange	Lights (Output) max. 0.1A
Pin 8 ● yellow	CAN-HIGH (Input)
Pin 9 ● white	Reverse gear (Output) max. 1.5A
Pin 11 ● black	Ground signal PDC
Pin 12 ● black	Ground

Instruction# 1697	Version# 1.06	Part# ntbp	EAN#	Author: KW
-------------------	---------------	------------	------	------------

Connect the CI-P2 harness to the aftermarket radio.

In case you ordered the **plug-and-play connection SET**, just connect the cable (marked Aftermarket Radio Remote) to the aftermarket radio's remote control input (please see radio installation manual) and connect the ISO connectors to the radio as well.

You're all done now.

Please test the installation prior to putting all panels back into its original position.

Remember to make sure that all canbus connections must be closed (climate control panel!) before you put ignition to position 2! (you'll get airbag failure reports otherwise!)

Instruction# 1697	Version# 1.06	Part# ntbp	EAN#	Author: KW
-------------------	---------------	------------	------	------------