

SWEDESOLUTIONS.COM

EVERYTHING FOR YOUR SWEDE

Kind	Installation and user manual
Title	Installation and user manual for MMSC (ABT)
Language	English
Version	1.1
Date	March 15 th 2023
Applicable to	MMHU-ABT
Contents	Describes installation and basic use of MMSC-ABT devices

FUNCTIONS MANUAL

Applicable to:

MMSC of any type (AUX or ABT)

Installation manual and description of connections.

Pre requirements for this document to be useful:

- Any Volvo with SC or SR radio, with focus on Volvo S70/V70/C70 1997-
- No known errors or failures in the electronics of your Volvo.

Need to know:

- Obviously we try to put as much information in a manual as we can. Sometimes things are "normal" and "of base logic" to us, which might not be for you, simply because you are not installing electronics in your car daily, and we are. Please in cases where we seem to miss out on information in a manual; think logically, measure power and/or contact us!
- In case you might have any questions, please email us at info@swedesolutions.com
- In case you remove power from the radio, you might need the **RADIO CODE** to enable the radio later. (For installation of the MMSC sets removing power connector from radio is NOT required, but might come handy in case wires are short!)

Start here:



Remove your SC or SR radio. (press the locks so they come out)



Pull the radio forward and tilt it facing down towards the gear shifter so you can reach the connectors in the back of the radio.

Instruction# 1697	Version# 0.6	Part# MMHU-ABT	Author: KW
-------------------	--------------	----------------	------------



Once tilted forward, find the large black connector. In case something else has already been connected to othe radio before, you might find tape or something there, just like in this particular photo.

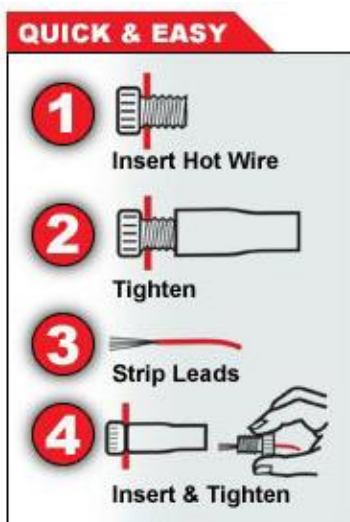

Instruction# 1697	Version# 0.6	Part# MMHU-ABT	Author: KW
-------------------	--------------	----------------	------------

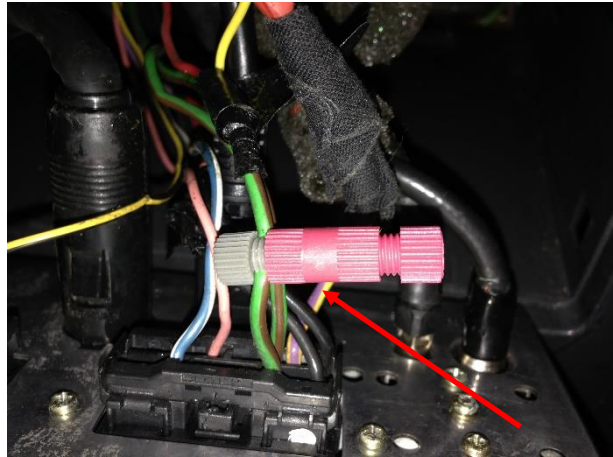
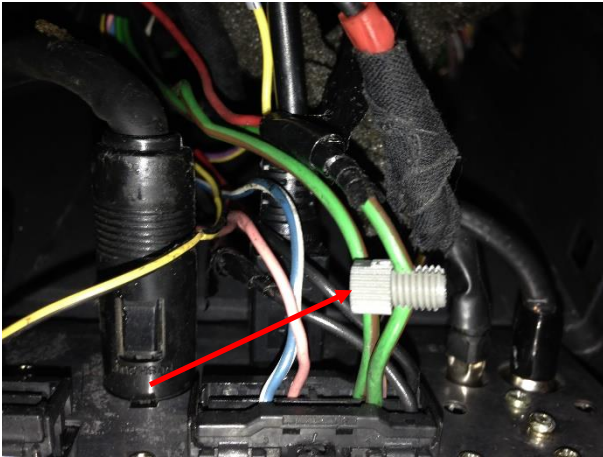

Find the 12V+ battery wire. (So power is always on!) Colors do differ! If possible measure. It's the **second wire from the top left**, looking at the radio; connectors facing towards you. (Green/brown in this photo). Connect the quick connect as shown (a red or blue quick connect has been supplied with your order).

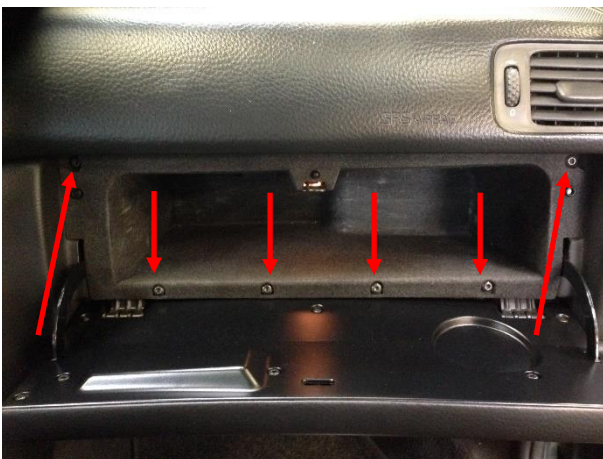

Open glove compartment and remove the torx screws holding it.

Instruction# 1697	Version# 0.6	Part# MMHU-ABT		Author: KW
-------------------	--------------	----------------	--	------------



Pull the glove compartment out and drill a whole of at least 10mm in the top (!) of the compartment. Then insert the supplied MMSC harness from inside the glove compartment to the outside.



Place the MMSC and connect the harness to it.

Instruction# 1697	Version# 0.6	Part# MMHU-ABT		Author: KW
-------------------	--------------	----------------	--	------------

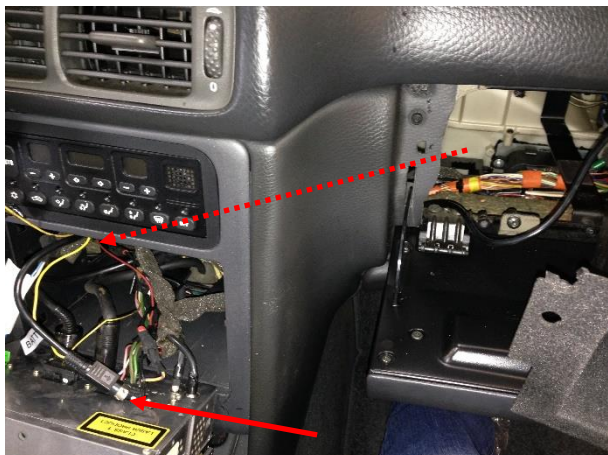

Push the MMSC harness towards the radio and connect the mini-din cable to the CD-Xchanger port and connect the yellow wire to the earlier placed quick connect.



Now its time to test. Please make sure all connections are finalized and push radio back into its slot a bit. Then put ignition of your Volvo to position 2 and select CD-C or 6CD or 10CD button on your radio.

Connect to Bluetooth (BTM, BTA or BTK profile, depending on the version you have!) and enjoy music.

If you want to use the MMSC set as handsfree set as well, you can now connect the microphone to the port on the MMSC.

Suggested place for microphone is on the left (if Left-hand-driven!) panel near the front window.

Instruction# 1697	Version# 0.6	Part# MMHU-ABT	Author: KW
-------------------	--------------	----------------	------------

FAQ

Q : Where do I install the unit?

A : Easiest is in the glove compartment. (just reach behind the radio to the direction of the glove compartment and you'll see that you can pass the cable to the glove compartment without drilling or so.

Q : How can I use the AUX, since BT is selected by default

A : To use aux, select the next CD on the SC. (Virtually of course).

Q : How can I use the BT streaming function

A : Connect your smartphone with Bluetooth to "BTK" (BlueTooth Kit). (Code 0000)

Q : How can I answer a call

A : Make sure the source of the radio is set to CD-C and answer the call from using your mobile phone or press the next button >>. If you want to hang up the call you can use the same button.

If you are already playing audio from Bluetooth, you can just answer the call directly.

Q : How can I make sure I hear the incoming audio from the call?

A : Set the SC to CD-C once you want to answer a call!